

# AFL227B

Ideal for back yards, parks, signs and so on. Designed for use with incandescent, metal halide, or mercury vapor lamps, the fixture accepts the popular PAR38 lamps.



## GENERAL SPECIFICATION

- UL and CUL listed for wet locations and landscape mounting
- Heavy duty die-cast aluminum powder coating, construction corrosion resistant hardware
- Knuckle allows total adjustability, suitable for either up or down lighting applications
- Lampholder E-26, UL approved
- Ideal for INCAN PAR38 150 Watts Max

## LINE DRAWING

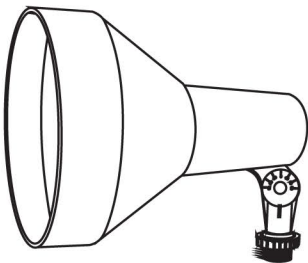

## DIMENSIONS

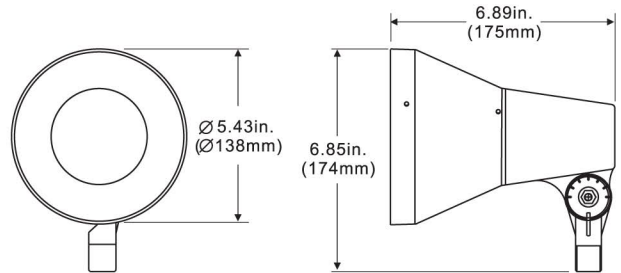

## ASSEMBLY PARTS



Mounting Plate

HH  
(Hood)

HG  
(Guard)

HV  
(Visor)

ITEM NO.

VOLTS

LAMP

FL227B-115

120/220

PAR38 150W/E26